

# DEERFIELD TOWNSHIP SECTION 23 R13 TWP 9 MORGAN COUNTY, OH

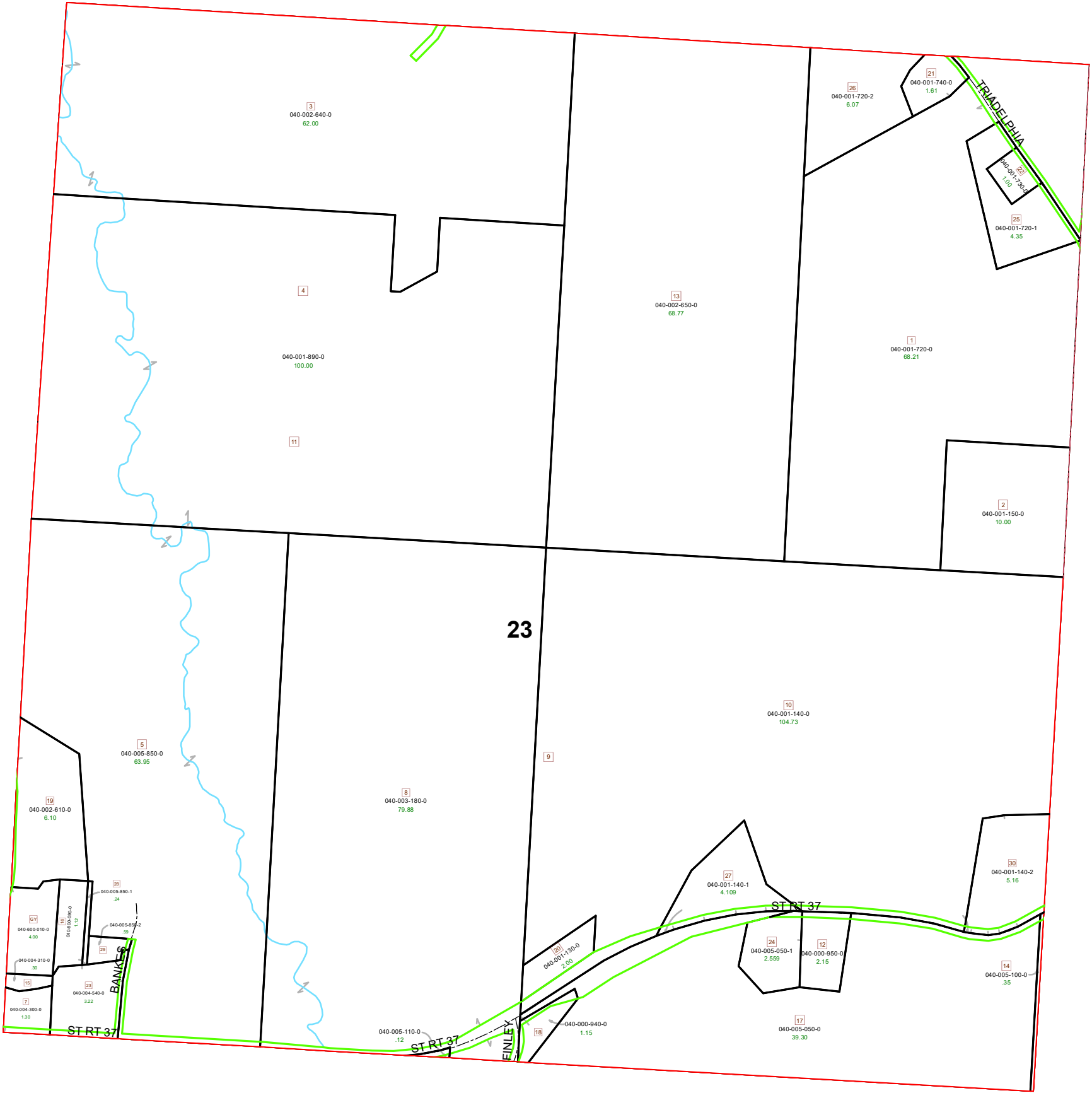

PIN	VOL	PAGE	Owner	LegalDescr	Acres
040-004-540-0	OR223	2786	BANKES BRANDON C & ALISA	R13 T09 S23 SD 23	3.22
040-005-850-2	OR223	2786	BANKES BRANDON C & ALISA	R13 T09 S23 SD 29	0.586
040-600-010-0	D.V 68	54	CEMETERY (DEERFIELD)	R13 T09 S23 0	4
040-000-940-0	D.V 190	365	COSGRAVE MICHAEL T	R13 T09 S23 SD 18	1.15
040-600-090-0	D.V 85	424	DEERFIELD CEMETERY ASSOC	R13 T09 S23 0	1.12
040-005-850-1	D.V 85	606	DEERFIELD CEMETERY ASSOCIATION	R13 T09 S23 SD 28	0.24
040-001-150-0	D.V 160	547	DODRILL CARL D JR & CONNIE RUTH LC-	R13 T09 S23 SD 2	10
040-005-850-0	D.V 167	213	DOUBLE R RANCH A PARTNERSHIP C/O	R13 T09 S23 SD 5 LI	63.954
040-001-130-0	OR16	692	FLYNN JAMES W SR & JAMES W JR	R13 T09 S23 SD 20	2
040-001-140-1	OR223	2806	FLYNN JAMES W SR & JAMES W JR	R13 T09 S23 SD 27	4.109
040-001-140-2	OR171	361	FLYNN JAMES W SR & JAMES W JR	R13 T09 S23 SD 30	5.16
040-001-140-0	OR16	692	FLYNN JAMES W SR & JAMES W JR	R13 T09 S23 SD 9-1	104.731
040-001-720-1	OR203	1435	HANN JOHN R JR	R13 T09 S23 SD 25	4.346
040-001-720-0	OR203	1435	HANN JOHN R JR	R13 T09 S23 SD 1	68.205
040-001-730-0	OR138	267	HANN LINDA DIANE	R13 T09 S23 SD 22	1
040-001-890-0	OR194	313	HINKLE ELLEN K TRUSTEE	R13 T09 S23 SD 4-1	100
040-002-610-0	OR217	816	LANE PAUL J & SANDRA K	R13 T09 S23 SD 19	6.1
040-004-300-0	D.V 203	787	LAPP NELSON A & ANNA CO-TRUSTEES	R13 T09 S23 SD 7 S	1.3
040-004-310-0	D.V 203	787	LAPP NELSON A & ANNA CO-TRUSTEES	R13 T09 S23 SD 15	0.3
040-001-740-0	OR64	462	MAST PHILIP & GRACE	R13 T09 S23 SD 21	1.61
040-001-720-2	OR64	462	MAST PHILIP & GRACE	R13 T09 S23 SD 26	6.069
040-005-050-1	OR230	989	MCGREW DEBORAH	R13 T09 S23 SD 24	2.559
040-003-180-0	OR74	242	MURPHY MAX E & RITA D	R13 T09 S23 SD 8 P	79.88
040-005-110-0			SIDWELL DONNA JEAN	R13 T09 S23 SD 8 P	0.12
040-005-100-0	D.V 195	28	SIDWELL DONNA JEAN	R13 T09 S23 SD 16	0.35
040-005-050-0	D.V 195	28	SIDWELL DONNA JEAN	R13 T09 S23 SD 17	39.298
040-000-950-0	OR140	92	SLONE TEDDY SR	R13 T09 S23 SD 12	2.153
040-002-650-0	OR195	138	TRIDELPHIA ENTERPRISES INC	R13 T09 S23 SD 13	68.77
040-002-640-0	OR195	138	TRIDELPHIA ENTERPRISES INC	R13 T09 S23 SD 3	62

**Boundaries**

- Future Split
- Parcel

**Type**

- Hydro
- ROW
- County
- Lot
- Section
- Township
- Symbols
- Roads

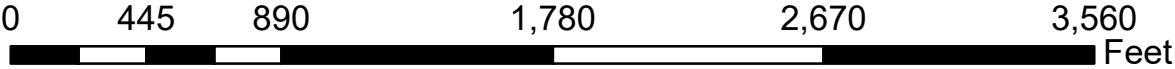

Source: Morgan County Engineer's Office  
 Author: Marcia Wolfe  
 Date: 5/22/2020



Disclaimer: The information that these maps contains is for reference purposes only. Please bring any errors to the attention of the Engineer's Office staff.  
 Thank you